

**10 Stanley Street #01-01**

NLA: 1,018 sf

BACK LANE

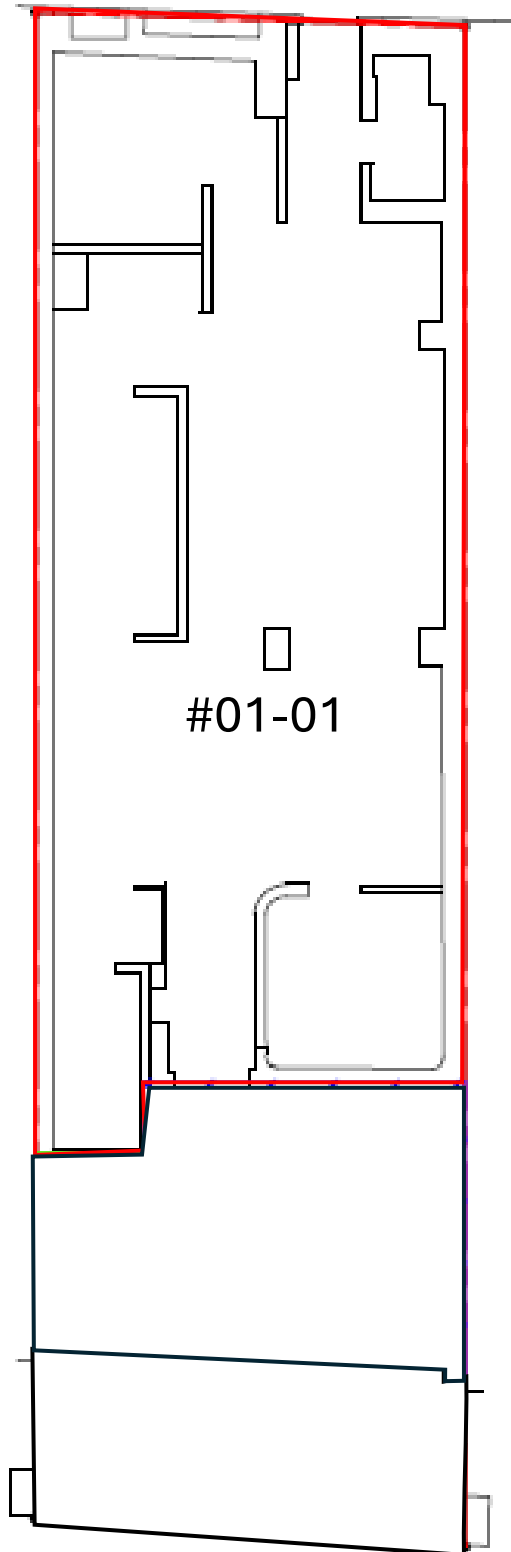

STANLEY STREET

BACK LANE

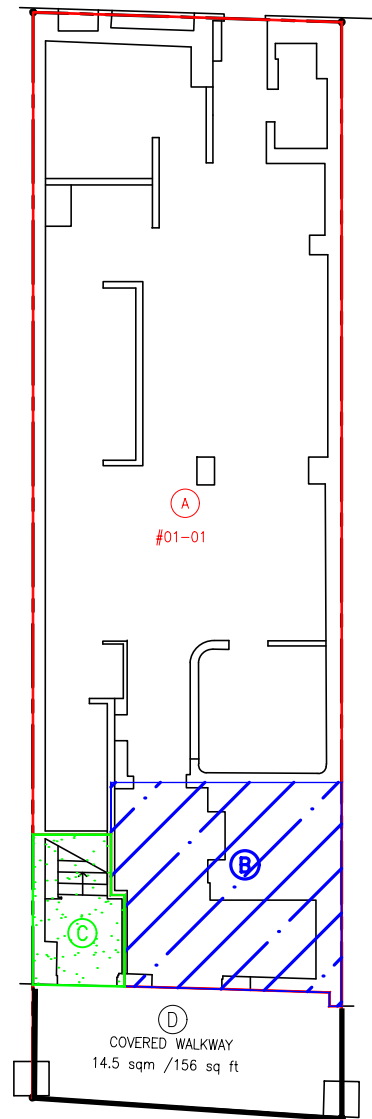

STANLEY STREET

1ST. STOREY

PARCEL	AREA (sq m)	AREA (sq ft)
A	94.6	1018
B	18.4	198
C	5.1	55
D	14.5	156

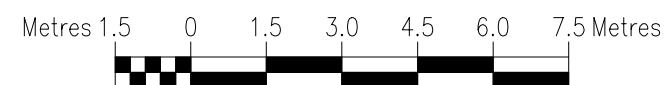

NOTES:1

1. Proposed lease boundaries and areas shown hereon are based on physical measurement on site.
2. Floor areas are shown to the nearest 0.1 sqm and 1 sq ft.
3. Information shown hereon is correct at the time of survey.
4. Date of survey : 17-07-2024.

PROJECT TITLE:

NET LEASABLE AREA SURVEY FOR  
LOT 99890K TS 02 AT No. 10 STANLEY STREET  
SINGAPORE 089669

DRAWING TITLE:

1ST STOREY

CLIENT :

M/S STANLEY STREET PTE LTD



J K FOO CONSORTIUM PTE LTD  
3023 UBI ROAD 3 #06-04  
UBI PLEX 1 SINGAPORE 408663  
Tel: +65 67427973  
e-mail: jkfoo@jkfoosurvey.com.sg

*Ang*  
ANG PHAR TING

REGISTERED SURVEYOR  
B.GEOSPATIAL, MSCS, MSISV  
REGISTRATION NO. 73

24-07-2024

ACAD VER : 2014    Surveyed by : JASON/DY    Computed by : -

Scale : 1:150    Drawn by : SCK    Checked by : KUAN

DWG Ref : A3-F9392-1\_FA    Sheet 1 of 2

ACAD File : F9392-1.DWG

COPYRIGHT RESERVED